



2310 E. Orangethorpe Ave, Anaheim, CA 92806

714-738-6194 / 714-446-0119 FAX

www.accrmfg.com

Series 11X9 - Extractor Lever Product Specification

Part Number Code:

11X9 S - X L CC TD E

Injector / Ejector Material Type

X = Material Type

0 = .063", 5052-H32 Aluminum Alloy

(per AMS-QQ-A-225/7 or QQ-A-250/8)

1 = .063", 6061-T6 Aluminum Alloy

(per AMS-QQ-A-225/8 or AMS-QQ-A-250/11)

2 = .063", Type 301 or 304 Stainless Steel

(per ASTM-A666, Passivate per AMS-QQ-ARD)

Handle Type:

S = Straight Handle

A = Angled Handle

Card Thickness Options:

2 = 2/32"

4 = 4/32"

3 = 3/32"

5 = 5/32"

Identification Option:

E = ESD Stamp

Blank = None Required

Leg Options:

T = Actuator Tab

D = Angled Leg

Blank = Straight Leg and no Tab

Finish Options:

CC = Chem-Film Clear per MIL-C-5541, Type1, Cl 3 (ROHS)

CG = Chem-Film Gold per MIL-C-5541, Type 1, Cl 1A

BA = Black Anodize per Mil-A-8625, Type II, Class 2

Other colors available on request (RA=Red, BU=Blue,

GN=Green, YW=Yellow, PP=Purple, OG=Orange)

Orientation Option:

L = Left Hand Part (Shown Below)

R = Right Hand Part (Opposite)

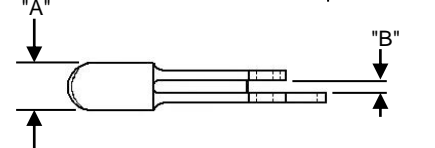
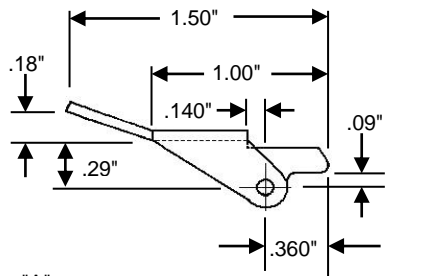

Standard / Angled Handle Easy Lift "A" Style Ejector (LH Shown)

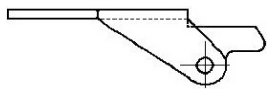

Straight "S" Style Ejector Handle

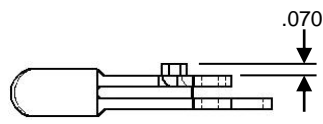
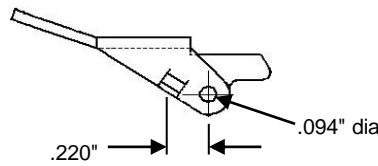

Actuator Tab "T" Option

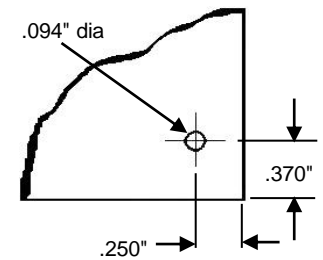

Circuit Board Mounting Data

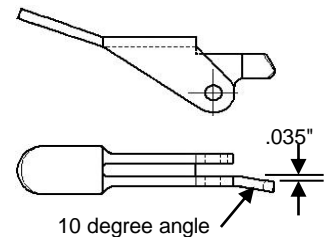

Angled Leg "D" Option

Dash No.	"A" dim	"B" dim
-2	0.25"	0.075"
-3	0.25"	0.105"
-4	0.29"	0.142"
-5	0.29"	0.165"

Tolerances:

.xx = +/- .020

.xxx = +/- .010

Unless otherwise specified

Note: Drawings are not to scale.

FEATURES:

*Strong Lever Action Design Provides Excellent Mechanical Advantage for Safe and Efficient Extraction of Circuit Boards.

*Area Available for Identification Marking on Handle.

*Available with Conductive Finish.

*Aluminum Parts Available in Colors for Coding.

*Made In the USA. 100% DFAR's Compliant.

APPLICATION DATA:

Two Inserter-Extractors are recommended per board Provides Insertion and Extraction travel of .45" minimum with a mechanical advantage of approximately 4.5 : 1.

Meets the requirements of DSCC 84191.